

SIDE VIEW

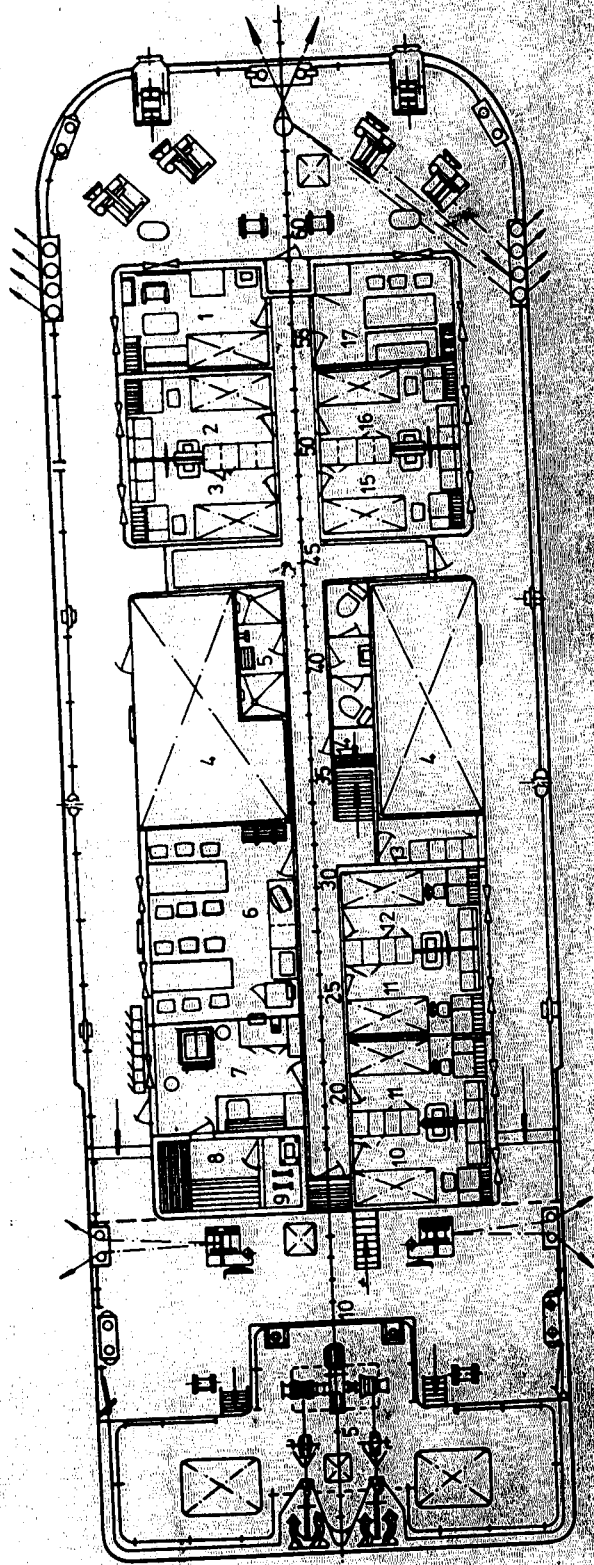

MAIN DECK

PUSHER OF 2*1200 HP

CLASSIFICATION SYMBOL: $\frac{RNR}{CM} \uparrow \downarrow$

MACHINERY DETAILS

ENGINEBUILDER : I.C.M. Reșița
 MAKE : Sulzer
 TYPE : 2*6LDSR 28 J(K)
 OPER. PRINCIP. : diesel
 irreversible
 four-strokes
 single acting

NO. OF CYLIN. : 6
 BORE * STROKE : 280 mm * 360 mm
 POWER : 2*1200 bhp (2*883 kW)
 REVOL. SPEED : 750 rpm
 TRANSMISSION : reverse reduction
 PROPELLERS : 2*FBP
 FUEL TYPE : diesel oil
 CONSUMPTION : 170 g/hph (125 g/kWh)
 FUEL BUNKERS : 87 t
 SPEED : 20.00 km/h
 GENERATORS : 175 175 46kW 400V 50Hz
 AC

TONNAGES

Δ_m : 370 t
 LC : 121 t
 Δ_M : 490 t

DIMENSIONS

LOA : 34.60 m
 LBP : 33.20 m
 B : 11.00 m
 D : 2.80 m
 d_m : 1.57 m
 d_M : 2.00 m

HULL DETAILS

SHIPBUILDER : S.N. Oltenița
 MATERIAL : steel
 JOINT : welded
 NO. OF DECKS : 1

NAVIGATION AIDS AND RADIOCOMMUNICATION EQUIPMENT:

radar
 radio-telephone

SISTER SHIPS:

| | |
|-----------|-----------|
| Bacău | Teleorman |
| Bihor | Timișoara |
| Brașov | Tulcea |
| Cluj | Vaslui |
| Comănești | 5975 |
| Covasna | 7238 |
| Craiova | 7239 |
| Dolj | 7240 |
| Găiești | 7241 |
| Gorj | 7242 |
| Harghita | 7381 |
| Oradea | 7382 |
| Pitești | 7383 |
| Suceava | |

ÎMPINGĂTOR DE 2*1200 CP

SIMBOL CLASIFICARE: $\frac{RNR}{CM} \uparrow \downarrow$

CARACTERISTICI MAȘINI

CONSTRUCTOR : I.C.M. Reșița
 LICENȚA : Sulzer
 TIP : 2*6LDSR 28 J(K)
 PRINCIPULI DE : diesel
 FUNCȚIONARE : ireversibil
 4 timpi
 simplu efect

NR. CILINDRI : 6
 DIAM. * CURSA : 280 mm * 360 mm
 PUTERE : 2*1200 CPE (2*883 kW)
 TURĂȚIE : 750 rpm
 TRANSMISIE : reductor-inversor
 PROPULSOR : 2*EPF
 TIP. COMB. : motorină
 CONSUM : 170 g/CPH (125 g/kWh)
 BUNKER : 87 t
 VITEZA : 20.00 km./h
 GENERATOARE : 175 175 46kW 400V 50Hz
 CA

TONAJE

Δ_m : 370 t
 Cl : 121 t
 Δ_M : 490 t

DIMENSIUNI

L_{max} : 34.60 m
 L_{pp} : 33.20 m
 B : 11.00 m
 D : 2.80 m
 d_m : 1.57 m
 d_M : 2.00 m

CARACTERISTICI CORP

CONSTRUCTOR : Ș.N. Oltenița
 MATERIAL : oțel
 ÎMBINARE : sudură
 NR. PUNȚI : 1

ECHIPAMENTE DE NAVIGAȚIE ȘI RADIOCOMUNICĂȚIE:

radar
 radiotelefon

NAVE SURORI:

| | |
|-----------|-----------|
| Bacău | Teleorman |
| Bihor | Timișoara |
| Brașov | Tulcea |
| Cluj | Vaslui |
| Comănești | 5975 |
| Covasna | 7238 |
| Craiova | 7239 |
| Dolj | 7240 |
| Găiești | 7241 |
| Gorj | 7242 |
| Harghita | 7281 |
| Oradea | 7382 |
| Pitești | 7383 |
| Suceava | |